



XPV SERIES

The Chem-Tech XPV Series pump combines the best in variable speed peristaltic pump technology with state of the art control electronics, providing unparalleled performance, control and value. The XPV represents the leading edge of microprocessor performance management, that allows a variety of choices of input signal types, and onboard timer programs to customize this pump to any application. Of course, this pump is as rugged and reliable as it's fixed speed siblings, the XPF and the XPA.

The electronic management system matches the **Variable Speed** motor to the real-time dosing requirements as directed by either a **4-20mA** signal, **Hall Effect** or **Dry Contact** pulse input, **External Stop** or manual operation in **Fixed Speed** mode. The pump can even be programmed with a **Cycle Timer** to run automatically at set intervals, or with a **Daily Timer** to add chemical based on days of the week.

The large **LCD Display** allows for simple, intuitive program selections, and clearly displays operating parameters. The **Flow Totalization** menu accurately reports the volume of chemical pumped at the touch of a button.

Tubing Materials - Our standard Norprene tube material is available in Low Pressure ratings which offer extended tubing life, and High Pressure ratings to meet demanding system requirements. The optional Fluran material tubing offers greater chemical resistance; contact Technical Service for compatibility.

Duplex Head Models - These models utilize two pump heads to deliver twice the flow, or the rated flow of two different chemicals simultaneously.



Variable Speed

Fully Scalable 4-20mA Input

Hall Effect Input

Flow Totalization

Cycle Timer

Daily Timer

LCD Display

*Contacting Head
Water Meter Input*

Chem-Tech XPV Series Selection Guide

MODELS:	Pump Size	Flow	Pressure Rating - PSI (Bar)			Tube Size	Speed (RPM)
			'H' Tube	'L' Tube	'F' Tube		
	XP008	8 GPD (1.3 LPH)	125 (8.6)	80 (5.5)	60 (4.1)	2	65 Max.
	XP017	17 GPD (2.7 LPH)	110 (7.6)	70 (4.8)	50 (3.4)	3	
	XP033	33 GPD (5.2 LPH)	100 (5.9)	50 (3.4)	40 (2.8)	4	
	XP055	55 GPD (8.7 LPH)	80 (5.5)	40 (2.8)		6	60 Max.
	XP100	100 GPD (15.8 LPH)		25 (1.7)		8	

ELECTRICAL:	L	115V, 60Hz
	H	230V, 60/50Hz
	R	230V, 60/50Hz with Grounded Right Angle European Plug

DRIVE:	V	Variable Input Control with I/O Cable
	G	Duplex Head - Low Pressure Norprene with 1/4" Tube Fitting

TUBING:	L	Low Pressure Norprene with 1/4" Tube Fittings
	H	High Pressure Norprene with 1/4" Tube Fittings
	3	Low Pressure Norprene with 3/8" Tube Fittings
	4	High Pressure Norprene with 3/8" Tube Fittings
	F	Fluran, Acid resistant tubing with 1/4" Tube Fittings
	G	Fluran, Acid resistant tubing with 3/8" Tube Fittings

SYSTEM:	X	Pump Only
	1	15 Gallon Tank System
	3	35 Gallon Tank System
	T	15 Gallon ITS System

A completed model should look like "XP033LVLX"

Specifications		Optional
Turndown Ratio	100:1	
Max. Viscosity	300 Cps	
Enclosure	NEMA 3R / IP31 (In Horizontal Position)	
Temperature Limitations	125F / 51C max.	
Electrical Requirements	115V / 60 Hz	230V / 50/60Hz
Shipping Weight	8 lbs. / 3.63kg.	

* Specifications subject to change without notice

Dimensions *All dimensions expressed as inches [mm]

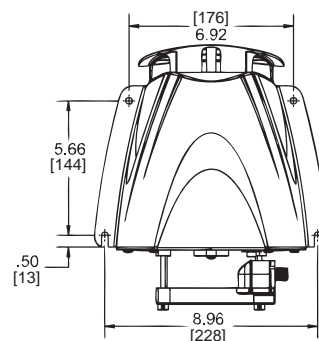
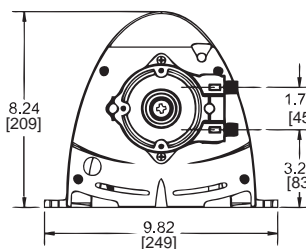
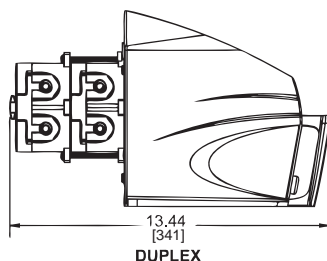
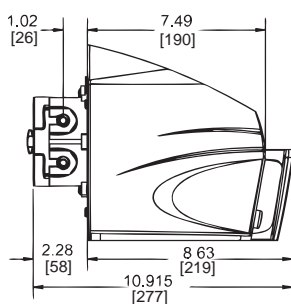

An ISO Certified Company

PULSAFEEDER

IDEX
FLUID & METERING

CTI-010 E09

Standard Product Operations

27101 Airport Road • Punta Gorda, Florida 33982
TEL (941) 575-3800 • TEL 800-333-6677
FAX (941) 575-4085 • FAX 800-456-4085
spotech@idexcorp.com • www.pulsafeeder.com