

# DUCTILE IRON CLOSE COUPLED ROTARY GEAR PUMPS

## GEAR PUMPS SERIES C992T

## PERFORMANCE

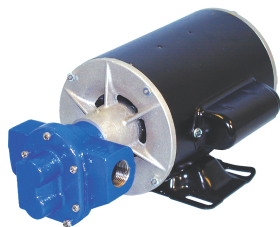

### FEATURES

- Compact Dimensions
- Rugged Ductile Iron Construction
- Hardened Steel Shafts
- Fluoroelastomer Lip Seal
- Self-Lubricating Carbon Bearings (Optional Flanged Bearings C992T-F)
- O-Ring Cover Seal for Maximum Leak Protection
- Durable Paint Finish
- Drop-In Replacement for Haight Model 5E001000

### DRIVE

The C992T pump head features a male mounting hub and tanged drive shaft. It mounts directly to specifically modified 56Y frame motors - Oberdorfer™ F33 Part 2143 or Haight's (Leeson) M4C17DH66F. Our F33 motor is 60/50 HZ (4 Pole) ODP with capacitor start and rigid base.

### LIQUIDS AND TEMPERATURE

These pumps are suitable for all liquids that are compatible with bronze. Most common liquids are water, oil, and mild chemicals in the pH-range of 4 to 11. Viscous liquids require reduced shaft speeds of 1150 RPM or lower. Consult factory. Liquids containing solids, abrasives, powders or paint pigments are definitely not recommended for gear pumps. If abrasives are unavoidable, use a very low shaft speed. The recommended liquid temperature range is 32oF to 140oF for longest pump life. If more extreme temperature conditions exist, our factory should be consulted. Freezing of water-filled pumps can cause damage and must be avoided. Oils at low temperatures are very viscous requiring a lower speed or extra power.

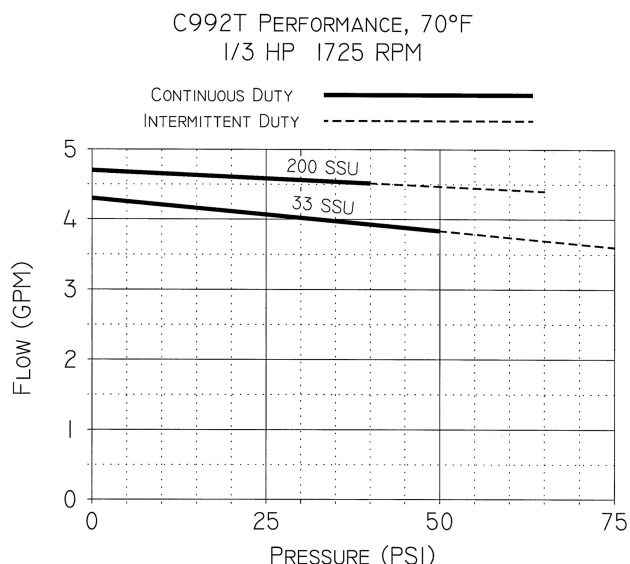

## **SUCTION LIFT**

Whenever possible, place the pump at an elevation below the liquid source. However since these positive displacement external gear pumps will generate 20" HG lift, this is not a requirement. As a general rule, place the pump as close to the liquid source as possible. For a first start-up, the pump should be primed to avoid dry running. Minimum size of the suction pipe is the size of the pump inlet port.

## EXPLODED VIEW AND PARTS LIST

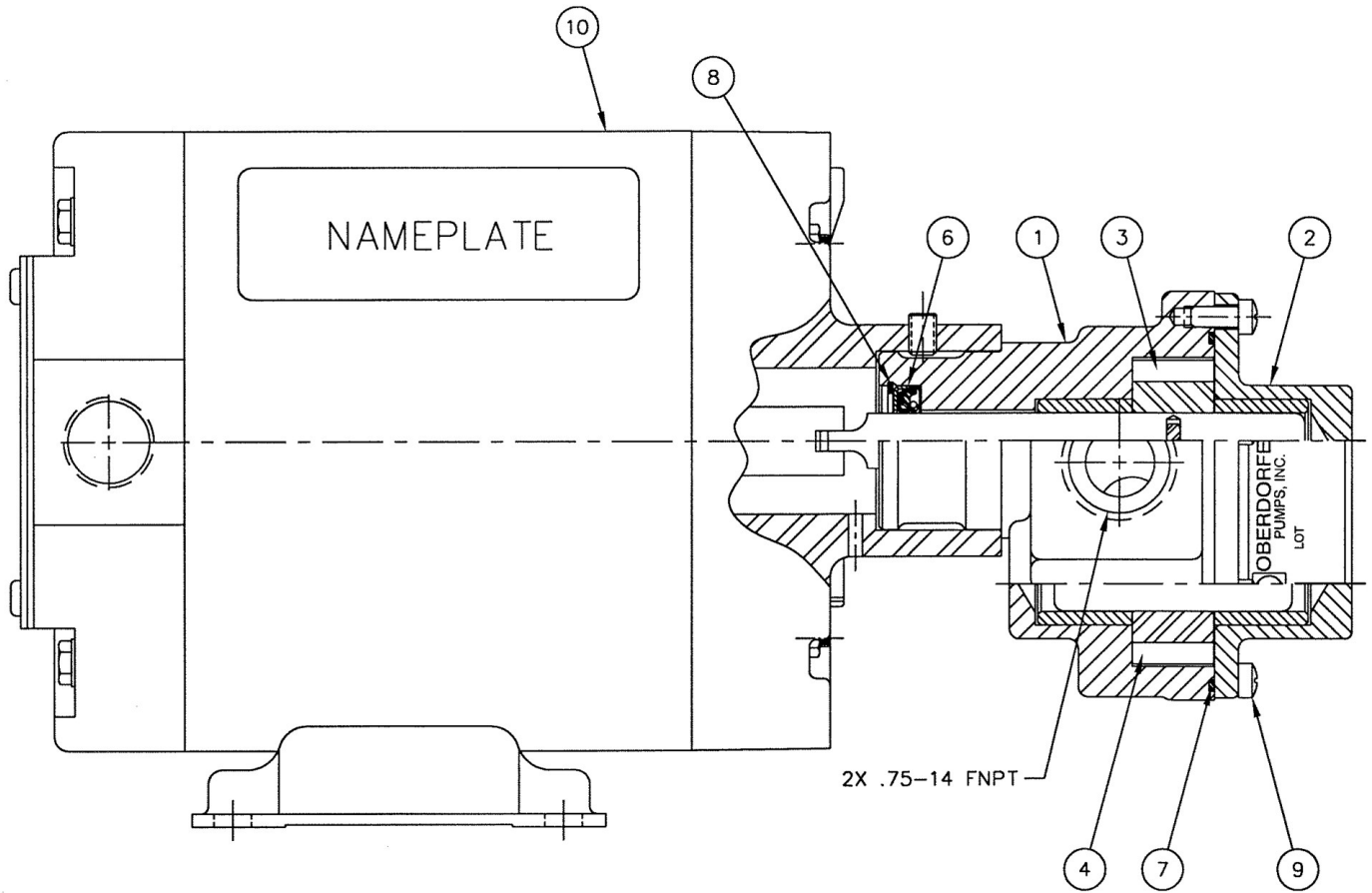

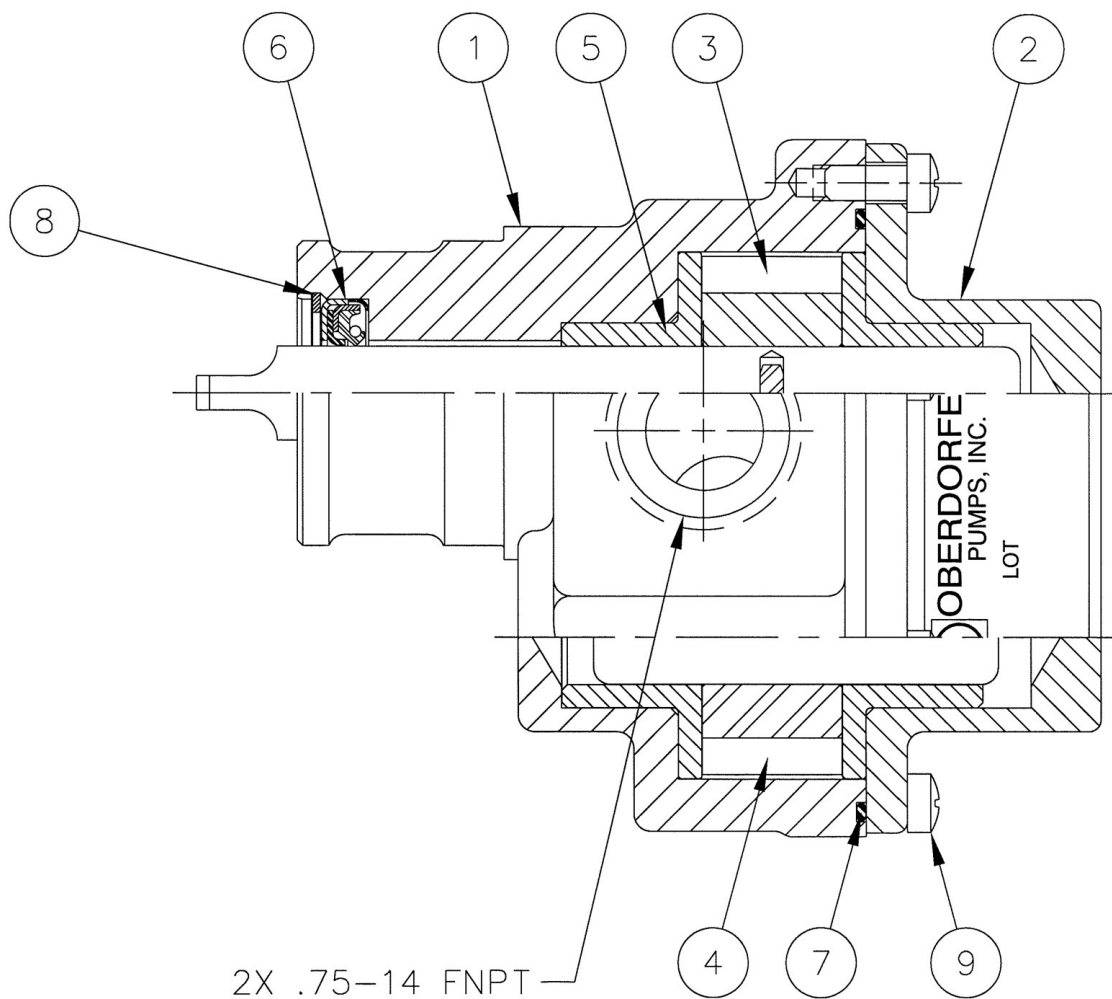

	1	2	3	4	5	6	7	8	9	10	11	Repair Kit
	Body	Cover	Drive Gear Assy *	Idle Gear Assy *	Bearing *	Lip Seal *	O-Ring *	Ret. Ring *	Screw	Motor	Dowel Pin	
Pump No.	Qty. 1	Qty. 1	Qty. 1	Qty. 1	Qty. 4	Qty. 1	Qty. 1	Qty. 1	Qty. 7	Qty. 1	Qty. 2	
C992T	2175-C	9316UN5N-C	33210	33120	5024	2165	9797-038	7639	5385	----	8885	12332
C992T-F33	2175-C	9316UN5N-C	33210	33120	5024	2165	9797-038	7639	5385	2143	8885	12332
C992TF	2175-F	9316UN5N	33210-F	33120	2135	2165	9797-038	7639	5385	----	8885	12333
C992TF-F33	2175-F	9316UN5N	33210-F	33120	2135	2165	9797-038	7639	5385	2143	8885	12333

\*Repair Kits contain items 3, 4, 5, 6, 7, 8

## DIMENSIONS

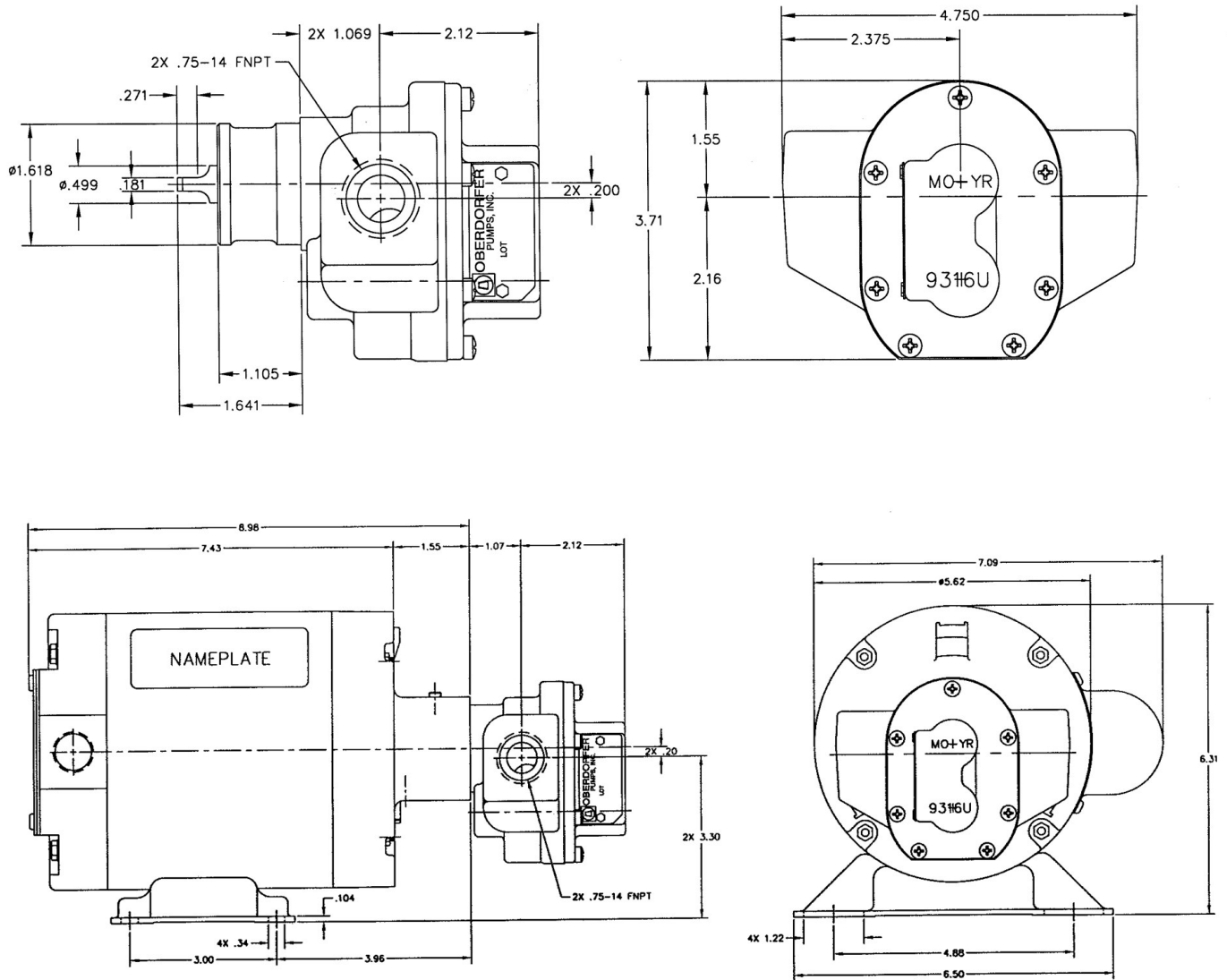

## ROTATION AND RELIEF VALVE

These pumps are bidirectional. The standard pump motor unit is set up for normal rotation (clockwise when viewing the pump from the shaft end). Reversing the motor rotation will reverse the "in" and "out" ports. These pumps are positive displacement devices capable of generating high line pressure. Discharge lines should be fitted with properly sized line pressure relief valves to protect the pump, motor, and downstream system. The relief outlet should be piped back to the suction vessel.